



For Security
Fixed Focal

YF8A-2

Applicable camera (model)

1 2/3 1/2 1/3 1/4

FIXED

Fixed Focal

MANUAL

Manual Iris

CS-mt

CS Mount

F1.2

Wide Aperture Rate



- Compact and lightweight design of 30g, best suited for built-in lenses.
- Wide aperture of F1.2, optimizing the performance at low lighting intensity.

*Photograph is a similar model.

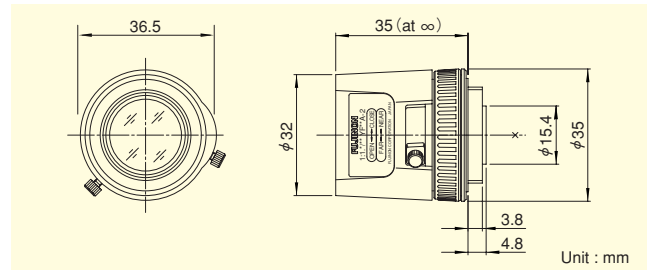

Unit : mm

Focal Length (mm)		8
Iris Range		F1.2 ~ Close
Operation	Focus	Manual
	Iris	Manual
Angle Of View (H×V)	1/3"	33°24' × 25°22'
	1/4"	25°22' × 19°09'
Focusing Range (From Front Of The Lens) (m)		∞ ~ 0.1
Object Dimensions at M.O.D. (H×V) (mm)	1/3"	71 × 53
	1/4"	53 × 40
Back Focal Distance (in air) (mm)		8.81
Exit Pupil Position (From Image Plane) (mm)		-147
Filter Thread (mm)		—
Mount		CS
Mass (g)		30
Remarks		



For Security
Fixed Focal

YF16A-2

Applicable camera (model)

1 2/3 1/2 1/3 1/4

FIXED

Fixed Focal

TELE

Telephoto Long Focal

MANUAL

Manual Iris

CS-mt

CS Mount

F1.4

Wide Aperture Rate



- Telephoto lens with the horizontal field angle of approximately 17 degrees.
- Compact and lightweight design of 25g, best suited for built-in lenses.
- Wide aperture of F1.4, optimizing the performance at low lighting intensity.

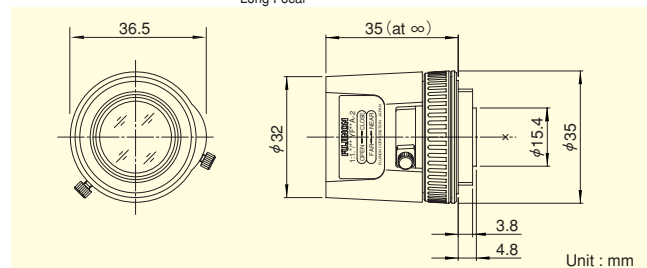

Unit : mm

Focal Length (mm)		16
Iris Range		F1.4 ~ Close
Operation	Focus	Manual
	Iris	Manual
Angle Of View (H×V)	1/3"	17°04' × 12°50'
	1/4"	12°50' × 9°39'
Focusing Range (From Front Of The Lens) (m)		∞ ~ 0.5
Object Dimensions at M.O.D. (H×V) (mm)	1/3"	153 × 115
	1/4"	115 × 86
Back Focal Distance (in air) (mm)		10.30
Exit Pupil Position (From Image Plane) (mm)		80
Filter Thread (mm)		—
Mount		CS
Mass (g)		25
Remarks		